

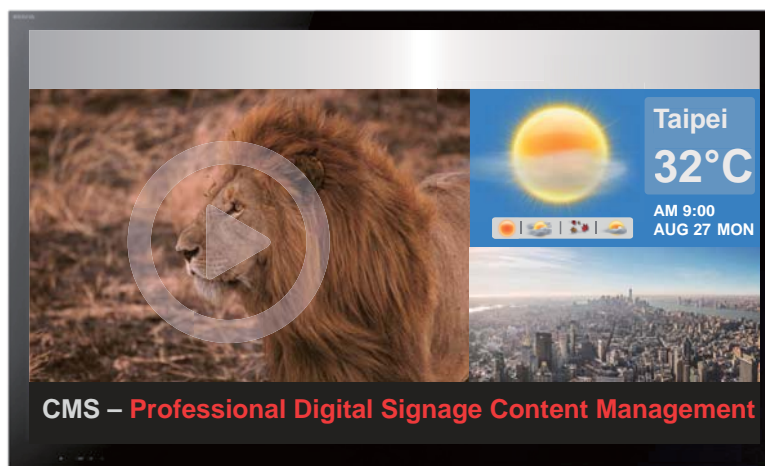

Digital Signage Content Management System



- User-friendly setting interface and scheduling management
- A variety of multimedia supported: marquee texts, photos, music, video and weather
- Centralized content management and broadcasting over internet
- Centralized device management and real-time monitoring by group
- Access control to secure the system



Product Overview

CMS (Content Management System), integrating internet, information and multimedia technology, offers a solution that can edit, control and playback a variety of multimedia materials (videos, images and streaming media) and

then stream them on monitor, TV, LED display, TV Wall, touch-screen, and projector, with any split-screen format for creative and flexible display of information and content.

Functionality



Format Editing - Support random split-screen function, both landscape and portrait orientation, as each playing area allows any combination, division and content editing at any resolution.



Programming Editing - Support video, music, picture, marquee text, streaming media, HTML, RSS, weather, clock and touch-based interactive application.



Multi-media Materials
Video format: MPEG2/4, VOB, AVI, WMV, MOV, MP3, MKV, RMVB, FLV ...
Image format: JPG, BMP, GIF, PNG ...
Support Video Streaming.



Weather Information - Display temperature, weather information, with quick search, sorting and auto-update by city.



Publishing Approval - Support programming approval prior to release and publishing.



Access & Clearance Management - Set-up, editing and modification of access and clearance grouping can be set by managers as per required.



Terminal Management - Able to snapshot any real-time display of the advertisement board, as well as perform all control steps such as switch on-and-off, re-boot, programming-stop-and-go.



Multi-terminal Management - Able to manage up to 1024 terminal boards, while within firewall without real IP.

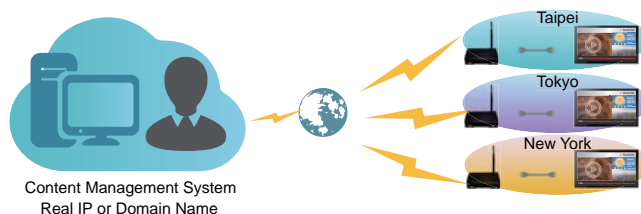
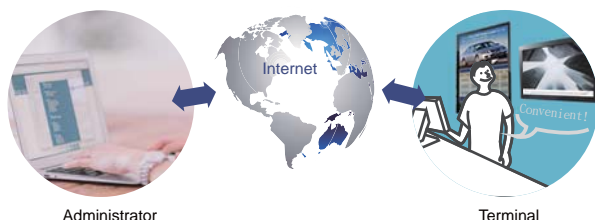

Material Management - Support multi-layer cataloging, catalogue or content upload, preview and various editing steps (e.g. delete, download and renaming, etc.).



Auto On / Off Scheduling - Automatically switch on-off as designated.



Playback Statistics - Playback count, duration, time / date as well as group playback.



Offline Programming via USB - Support offline programming via USB upload.

System Architecture

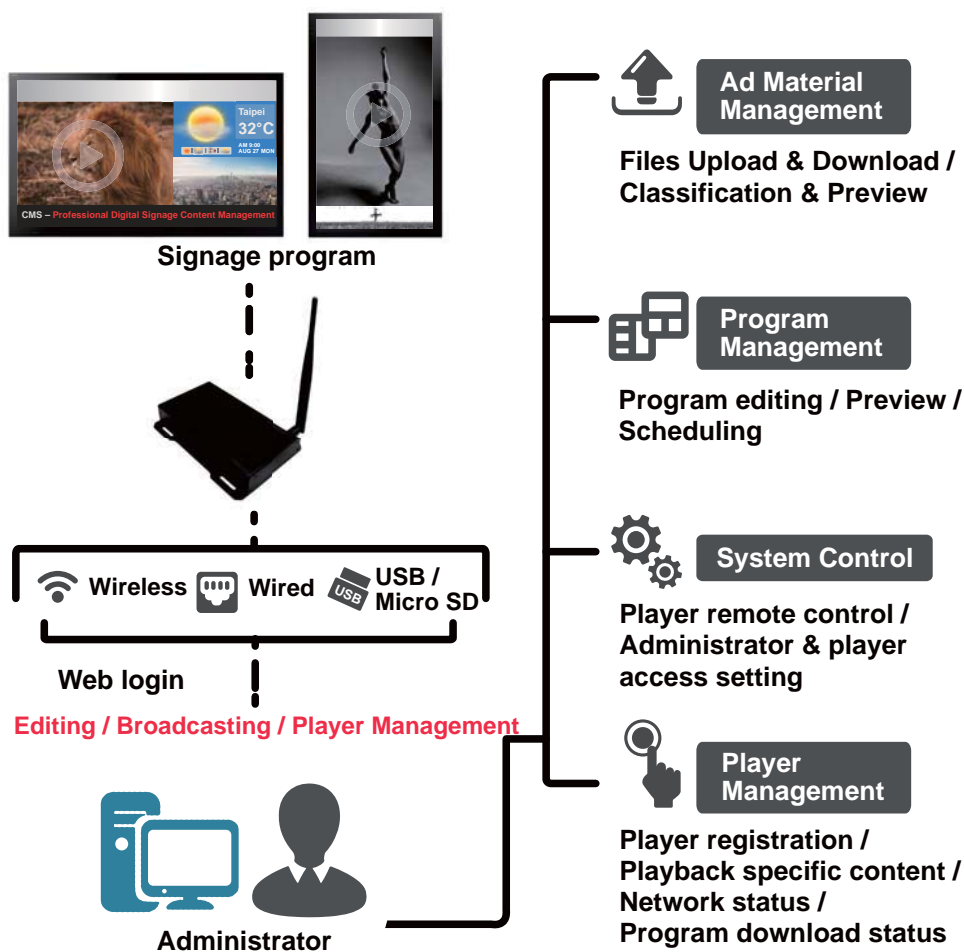

Ordering Information

| Content Management System | | Entry Level CMS01 | Intermediate Level CMS02 | Professional Level CMS03 |
|---------------------------|---|----------------------|-----------------------------|-----------------------------|
| Features | Picture, Video, Audio, Text, Data, Time, Week, Weather, Web, Container, RSS | ● | ● | ● |
| | Interactive Touch | × | ● | ● |
| | Ad Area, Streaming, Countdown | × | × | ● |
| | Ad Management | × | × | ● |
| | Program Editor | ● | ● | ● |
| | Terminal Management | ● | ● | ● |
| | Resource | ● | ● | ● |
| | Send / Clearance Check | ● | ● | ● |
| | Scheduling / Statistics | ● | ● | ● |
| | Clearance Management | ● | ● | ● |